

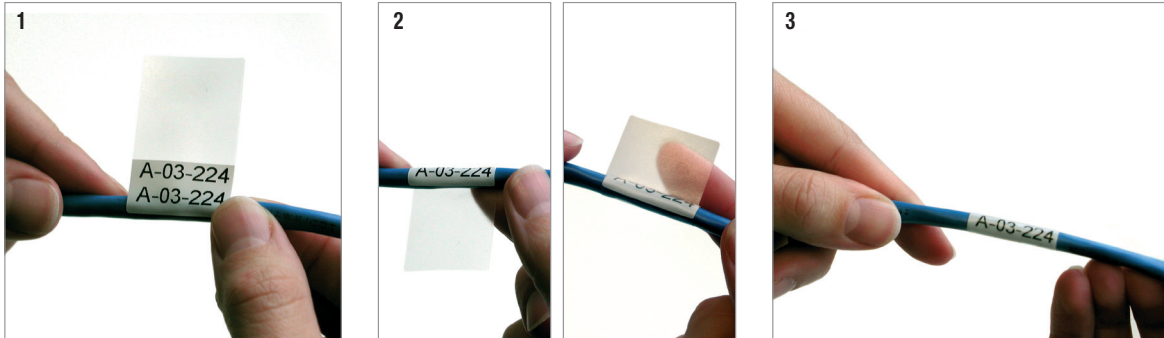

WIRE & CABLE MARKING SPECIFICATIONS

SELF-LAMINATING MARKERS

The images below demonstrate the principle of the self-laminating labels. The label is wrapped around the wire while the self-laminating part covers the printed area, thus completely protecting the legend.



1 Apply the printed area to your wire.

2 Wrap the clear area around the wire, covering the printed area.

3 Once applied the clear laminate will protect your legend for years to come.

Finding the correct label height for your Self Laminating labels

If you know your wire diameter or wire circumference, you can easily determine the correct label height by using the formula below.

Step 1: Wire Diameter x 3.147 (π) = Wire Circumference

Step 2: Wire Circumference x 1.5 (allowing label to wrap 1.5 times around wire) = Total Label Length

WIRE-DIMENSION GUIDE

The following table shows the relationship between the diameter and the copper surface in mm². This is a measuring method that is widely used in the electrical industry. However, this table should be used only as a guideline as it only refers to the most commonly used types of wires.

External diameter (mm)	Copper surface section wires (mm ²)
1.8 – 2.2	0.5
2.2 – 2.6	0.75
2.6 – 3.0	1.0
3.0 – 3.4	1.5
3.4 – 3.8	2.5
3.8 – 4.2	4.0
4.2 – 4.6	6.0
4.6 – 5.0	

PERMASLEEVE™ PRODUCT SELECTION GUIDE

Outside Wire Diameter (mm)	1	2	3	4	5	6	7	8	9	10	11	12	13	1
PERMASLEEVE™ B-342	3PS-094	3PS-125	3PS-187	3PS-250	3PS-375	3PS-500	3PS-1000 ⁹							24.13 mm